

Office ECoil46 – Manual Punch and Power Coil Binding Machine

Power Roller Binding
Features extra DURABLE roller

Large Trash Drawer
At back side of machine

Foot Pedal operated
Not shown

Punch Handle
High strength die cast metal

Full Die Disengagement Pins
For clean and complete punching
with different paper sizes

Open Punch Throat
For punching larger
document sizes

Side Margin Control
For evenly centered
document punching

Punch Margin Control
Maximizes the tear resistance
of all documents



Non Skid Feet

Punching Capacity
Up to 12-15 sheets (20 lbs)

Sturdy Die Cast Metal Construction
For many years of worry free operation

Digital Finishing Group

1260 Kempar, Madison Heights, MI 48071, U.S.A. Phone: 248-733-0400, Fax: 775-587-5352

Email: info@dfgus.com Website: www.dfgus.com

Warning:

Do not connect this product to electrical power or attempt to operate it before you read these operating instructions and have been fully trained to operate this product.

1. Indoor use only. Do not expose to rain.
2. Keep hands, long hair, neckties, necklaces and other loose articles away from roller.
3. Do not place this product on an unstable stand, cart, or surface. The product may fall and hurt you. If you use a cart, move the product and cart carefully.
4. Do not insert objects or spill liquids into the product. They may short out components that may result in fire.
5. The power outlet shall be installed near this product and shall be easily accessible.
6. Unplug the product before moving it. Unplug the power supply when it will not be in use for an extended period of time.
7. Do not attempt to service this product. Contact your DFG or your dealer if you need service.
8. In case you need to replace fuse, please use 3.0 A fuse.
9. **Do not operate the machine when the cover is not on the machine.**

This machine should only plug into 110 V single-phase power outlets. When using the roller, some motor and roller noises are normal. Roller is tested to last 10,000+ binding. We provide one-year part and labor warranty for this machine.

Dear Customer,

Thank you for purchasing our Office ECoil46 (EC46) machine. The following are basic installation and operation instruction for the EC46 machine. If you still have questions after reading this manual, please contact DFG.

Installation

Remove the blue knob from machine. Slide the punch handle on the exposed knob. Screw the blue knob back onto machine. Connect power cord and connect the foot pedal.

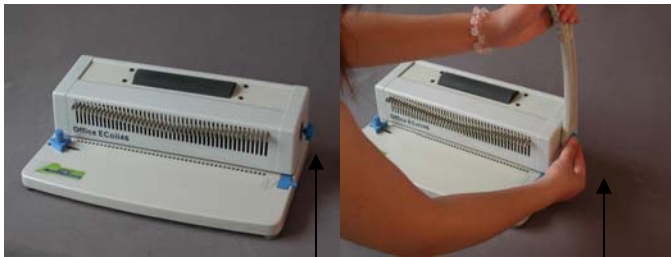

Remove the blue knob

Install the punch handle and blue knob

Connect foot pedal and power cord (not shown)

How to Punch

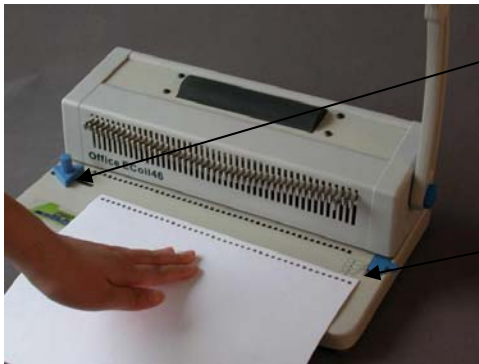

1. Set the side guide to center the sheet for punching

2. Select the punch margin (tip – the thicker the book, the larger the punch margin can be. However, you can use a small punch margin for any book)

3. Make sure your sheets are all the way inside, against the back wall, and then move sheets to the left side against the side guide. Pull the punch handle to punch the sheets.

How to Bind Books with Power Roller (up to 3/4")

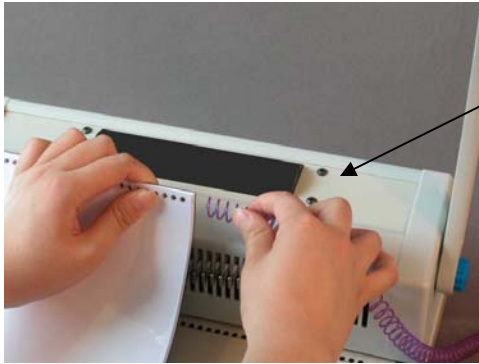

1. Manually turn the spiral coil into the first 4 or 5 holes

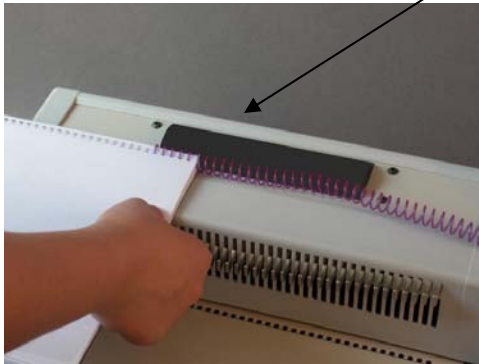

2. Press the foot pedal. Touch the coils against the moving roller to spin the coil through the book. (Tip - You can speed up binding by moving the book to the right side while the roller is spinning the coil through the book)





3. Cut and crimp the ends of the spiral coil.

Right handed

- A. Hold pliers with red dot up, with the coil near you.
- B. Place pliers with jaws inside the coil, near the center.
- C. Close the pliers to cut the coil and keep them closed
- D. Optionally twist pliers to bend crimp more before releasing
- E. Release coil, flip the book over sideways and crimp the other side using the same procedure (coils still near you)



Left handed

Use pliers as described above but hold them in your left hand and put the red dot down.

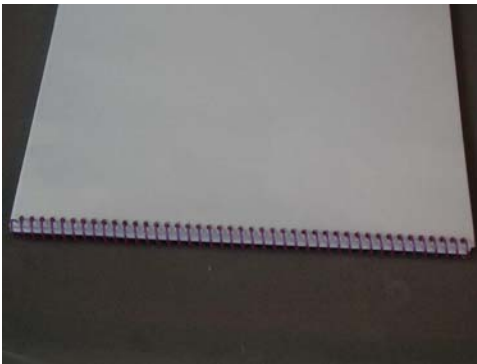

How to Make Books Manually for any thickness (EtitanCoil machine showed)

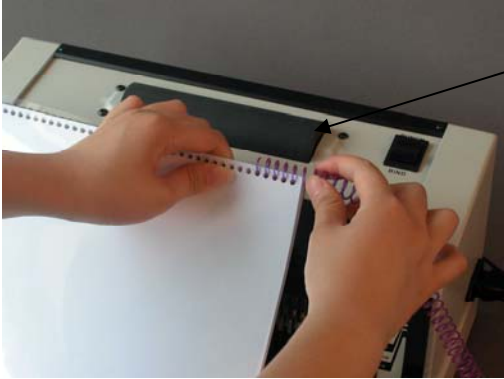

Manually turn your coil into the book. This is a very easy process. (Tip: It will be much easier to twist the front end of coils)

Cut and crimp the coils (see #3 of power roller binding)

How to Determine Appropriate Coil Size

There are two ways you can choose an appropriate coil size:

1. Use any size coil you like, as long as the coils size is larger than book thickness
2. Use coil that is 2 – 6 mm (1/8" to 1/4") larger than book thickness

Specification:

Punch: Max. 15 sheets of paper (20 lbs), 6-12 Normal

Punch size: Any size

Binding Size: Electric power binding up to 3/4". Manual binding to any size.

Electrical Coil Binding: up to 3/4"

Side Margin Control: Lets you center holes quickly and easily for perfect alignment

Punch margin control: Provide strongest binding for any book size

Open Throat: For punching any larger book length